



ALTERNATIVE ROUTES FOR TEMPORARY N3 ROAD CLOSURE between St James Avenue Interchange and the EB Cloete Interchange.

N3 Westbound Carriageway Closure (Durban to Pinetown):

- From 20:00, Tuesday 09 September 2025 to 04:00, Wednesday 10 September 2025

N3 Eastbound Carriageway Closure (Pinetown to Durban):

- From 20:00, Wednesday 10 September 2025 to 04:00, Thursday 11 September 2025

PLEASE NOTE THAT THE WESTBOUND CLOSURE OCCURS FIRST, FOLLOWED BY THE EASTBOUND THE FOLLOWING NIGHT.

Visit www.i-traffic.co.za/region/KwaZulu-Natal for more info

THIS IS THE DRIVE FOR A BETTER KWAZULU-NATAL

www.sanral.co.za



TMC Call Centre No 033 940 8484

Reg. No. 1998/009584/30 An agency of the Department of Transport.



SANRAL



BUILDING SOUTH AFRICA
THROUGH BETTER ROADS



TRAFFIC ADVISORY

SANRAL N2/N3 EB CLOETE UPGRADE - ROAD CLOSURES

Durban, 01 September 2025 - The South African National Roads Agency SOC Limited (SANRAL) advises motorists of upcoming night-time closures on the N3 between St James Avenue Interchange and the EB Cloete Interchange, to allow for the removal of temporary support bridge beams for the new Rockdale Bridge currently under construction.

"Construction continues on the new Rockdale Bridge, following its demolition in August 2024. Removal of the beams supporting its construction is a major step forward to the next phase of opening the bridge to traffic," said Corné Roux, SANRAL Eastern Region Project Engineer.

SCHEDULED CLOSURES:

- **N3 Westbound Carriageway Closure (Durban to Pinetown):**
Closed from 20:00 Tuesday 09 September 2025 to 04:00, Wednesday 10 September 2025
- **N3 Eastbound Carriageway Closure (Pinetown to Durban):**
Closed from 20:00, Wednesday 10 September 2025 to 04:00, Thursday 11 September 2025
- Please note that the Westbound closure occurs first, followed by the Eastbound the following night.

This initiative forms part of SANRAL's continuous efforts to enhance pedestrian safety and improve traffic infrastructure along both the N2 and N3 corridors.

As required for the safety of both road users and the construction team, full traffic accommodation plans and detour signage will be in place. These night-time closures have been scheduled to minimise daytime disruption.

All motorists are advised to plan ahead, allow for additional travel time, and adhere to posted signage and reduced speed limits within construction zones.

Trucks and heavy vehicles are advised to try and delay trips over this period and/or find suitable staging areas over this timeframe to avoid major congestion. Public transport operators are asked to ensure their drivers are aware of route closures and alternatives affecting their commuter routes.

A detailed alternative route guide is included below and can be found on this link: https://www.nra.co.za/project-n2n3-upgrades?region_id=eastern



CLOSURE LOCATIONS

N3 Westbound (Durban to Pinetown):

- N3 Westbound fully closed at EB Cloete Interchange (AKA Spaghetti Junction). Motorists can only proceed to the N2 North or N2 South ramps;
- N2 Northbound off ramp to N3 Westbound (from Amanzimtoti to Pinetown) closed at Spaghetti Junction;
- N2 Southbound off ramp to N3 Westbound (from Umhlanga Rocks to Pinetown) closed at Spaghetti Junction.

N3 Eastbound (Pinetown to Durban):

- N3 Eastbound fully closed at St James Avenue Interchange. The off ramp to Westville will remain open;
- St James Avenue loop ramp to Durban will be closed from Chesterville;
- St James Avenue left slip from Westville to Durban will be closed.

For editorial content or additional information contact Lwando Mahlasela on 082 440 4305

TEMPORARY N3 ROAD CLOSURES

between St James Avenue Interchange and the EB Cloete Interchange

Please note that the Westbound closure occurs first, followed by the Eastbound the following night.

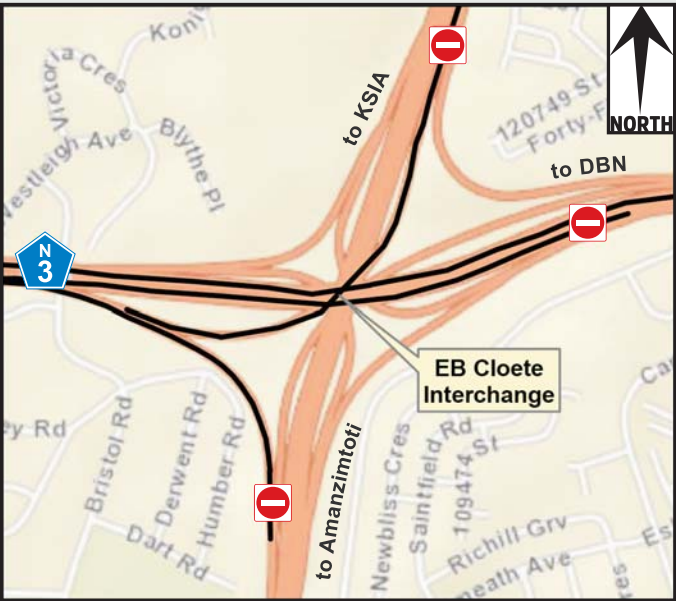

KSIA - King Shaka International Airport

N3 WESTBOUND CARRIAGEWAY CLOSURE (DURBAN TO PINETOWN):

From 20:00, Tuesday 09 September 2025 to 04:00, Wednesday 10 September 2025

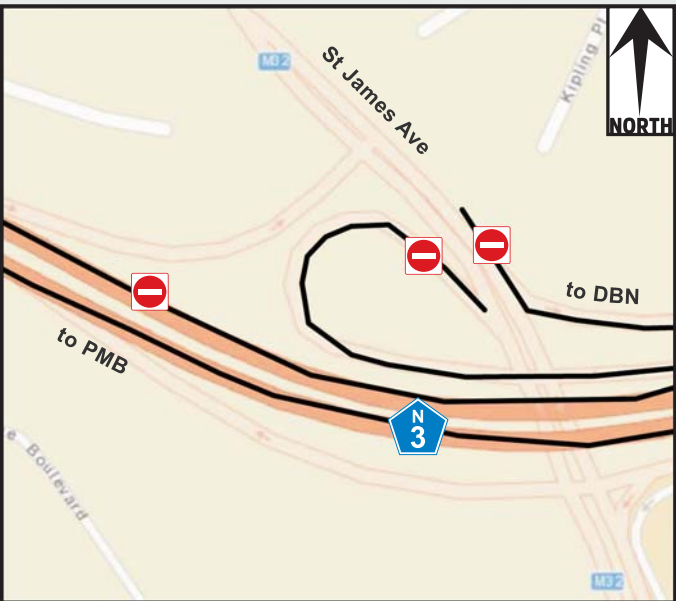

PMB - Pietermartizburg
DBN - Durban

N3 EASTBOUND CARRIAGEWAY CLOSURE (PINETOWN TO DURBAN):

From 20:00, Wednesday 10 September 2025 to 04:00, Thursday 11 September 2025



DETAILED ALTERNATIVE ROUTE GUIDE

These closures allow for the removal of bridge beams and form part of the construction of the new Rockdale Bridge over the N3 at Rockdale Road.

SCHEDULED CLOSURES:

N3 Westbound Carriageway Closure (Durban to Pinetown):

- From 20:00, Tuesday 09 September 2025 to 04:00, Wednesday 10 September 2025

N3 Eastbound Carriageway Closure (Pinetown to Durban):

- From 20:00, Wednesday 10 September 2025 to 04:00, Thursday 11 September 2025

Please note that the Westbound closure occurs first, followed by the Eastbound the following night.

NOTES TO READERS

Read together with the Alternative Routes Map. This identifies routes across the city for consideration as you plan your travel.

STEP 1

Consider whether you need to travel during the planned removal of temporary support bridge beams or if you can delay travel.

STEP 2

Identify the direction of your travel and find this direction in the headings of options provided overleaf.

STEP 3

Consider your travel options while referring to the route map provided.

STEP 4

Use your GPS Maps function ahead of travel to get up to date information that may affect your travel times. Visit www.i-traffic.co.za/region/KwaZulu-Natal.

STEP 5

Ensure you leave yourself enough time for the trip, noting potential speed limit changes and alternative route congestion.

Alternate Routes from West heading North

Remember that each travel option listed below is made up of a number of routes.

OPTION 1

Take Henry Pennington (Richmond Road) Off Ramp. Head North on Henry Pennington and Qashana Khuzwayo (Route 18). Turn Left onto Dumisani Makhaye Dr and turn right onto KwaMashu Highway (Route 10). Turn Left onto N2 (Route 15)

OPTION 2

Take Henry Pennington Off Ramp. Head North on Henry Pennington and Qashana Khuzwayo (Route 18). Turn left onto Dumisani Makhaye Dr and turn right onto Inanda Road (Route 12). Turn left onto N2 (Route 15).

OPTION 3

Take Henry Pennington Off Ramp. Head North on Henry Pennington and Qashana Khuzwayo (Route 18). Turn left onto Dumisani Makhaye Dr and turn right onto Queen Nandi Dr (Route 13). Turn left onto N2 (Route 15)

Alternate Routes from West heading South

Remember that each travel option listed below is made up of a number of routes.

OPTION 1

Take Henry Pennington (Richmond Road) Off Ramp. Turn right onto M1 Higginson Highway (Route 8). Turn Right onto N2 (Route 7)

OPTION 2

Take M7 Edwin Swales Off Ramp. Turn right onto M7 Edwin Swales (Route 16). Turn right onto N2 (Route 7)



Alternate Routes from East heading West

Remember that each travel option listed below is made up of a number of routes.

OPTION 1

Take Sherwood Off Ramp. Turn right onto M13 (Route 19). Continue on M13 until the M13 merges with the N3 at Shongweni.

OPTION 2

Take Sherwood Off Ramp. Turn right onto M13 (Route 19). Continue on M13 until the M7 Off Ramp. Turn left onto M7 (Route 9). Take N3 Off Ramp and merge onto N3 (Route 6a).

OPTION 3

Take Sherwood Off Ramp. Turn right onto M13 (Route 19). Continue on M13 until the Henry Pennington (Richmond Road) Off Ramp. Turn left onto Henry Pennington (Richmond Road) (Route 18). Turn right onto N3 Off Ramp and merge onto N3 (Route 6a).

Alternate Routes from West heading East

Remember that each travel option listed below is made up of a number of routes.

OPTION 1

Take Henry Pennington (Richmond Road) Off Ramp. Head North on Henry Pennington. Turn right M13 (Route 19). Continue on M13 (Route 19) until Sherwood Interchange. Turn left onto N3 (Route 6b). Continue East.

OPTION 2

Take M7 Off Ramp (Route 9). Head North on M7. Turn Right M13 (Route 19). Continue on M13 (Route 19) until Sherwood Interchange. Turn left onto N3 (Route 6b). Continue East.



OPTION 3

Take Spine Road (Route 11) Off Ramp. Head North on Spine Road. Turn right onto Jan Hofmeyr Rd. Turn left M13 (Route 19). Continue on M13 (Route 19) until Sherwood Interchange. Turn left onto N3 (Route 6b). Continue East.

Routes from East heading South

Not affected.

Routes from East heading North

Not affected.

Alternate Routes from North heading West

Remember that each travel option listed below is made up of a number of routes.

OPTION 1

Take KwaMashu Highway (Route 10) or Queen Nandi Drive (Route 13) or Inanda Road (Route 12). Turn left onto Dumisani Makhaye (Route 10). Turn right onto Qashana Khuzwayo and Henry Pennington (Richmond Rd) (Route 18). Turn right onto N3 (Route 6a)

OPTION 2

Take KwaMashu Highway (Route 10) or Queen Nandi Drive (Route 13) or Inanda Road (Route 12). Turn left onto Dumisani Makhaye (Route 10). Turn right onto St Johns Ave (Route 9). Turn right onto N3 (Route 6a)

OPTION 3

Take M19 (Route 17). Continue onto St Johns Ave (Route 9). Turn right onto N3 (Route 6a)



Routes from North heading South

Not affected.

Alternate Routes from South heading West

Remember that each travel option listed below is made up of a number of routes

OPTION 1

Take Higginson Highway Interchange. Turn left onto M1 Higginson Highway (Route 8). Turn left onto N3 (Route 6a)

OPTION 2

Take Edwin Swales Interchange. Turn left onto M7 Edwin Swales (Route 16). Turn left onto N3 (Route 6a)

OPTION 3

Take M19 (Route 17). Continue onto St Johns Ave (Route 9). Turn right onto N3 (Route 6a)

Routes from South heading East

Not affected.

Routes from South heading North

Not affected.

Alternate Routes between Westville and Chesterville

The Alternative or detour route will be via Bristol Bridge. These routes will be clearly marked for the road user.





ALTERNATIVE ROUTE MAP

Consider whether you need to travel during the planned removal of bridge beams. If it is possible delay travel. For up to date information please visit the official SANRAL website on www.nra.co.za

